

1st Floor West, St Martins Place
Phase 3 - Draft Accommodation Proposal
Jamila Ibrahim

SMP West 1st Fl 070313 07/03/2013

Existing Team allocations	Storage		
	Desk Allocation	High	Low
● Tony Zaman	1		1
● Tony Zaman's Team	67	↑	↑
● CSWT, CTPLD, OT and Care Service		17	4
● Heads of Service & Business Support Admin, Safeguarding, Re-Ablement		↓	↓
● Internal Audit & Risk Management (inc Investigations)	12	2	4
● AD Personalisation, Commissioning and Partnership	1		1
● Commissioning & Contracts	8	↑	
● Martin Lowers Procurement	3		
● Personalisation	1	2	
● Voluntary Sector Grants	3		
● Project Post Hot Desks	2		
● Policy & Communications	19	2	11
● Director's PAs	4		2
● Corporate Complaints	3	3	1
● Hot desks	1		
● Leader & Controlling Group	5		2
● PODs	2		
● CEO & Directors offices	3		7
Total	135	48	50

Proposed layout

- 1200 desks 135 existing plus 11 extra
- Tall Storage 52 actual. 48 existing cupboards plus 4 extra (which is equal to 8 Low cupboards)
- Low Storage 35 actual. 50 existing. 15 less cupboards, (Which is a loss of 7 cupboards)
- Meeting rooms 5 existing plus 1 extra
- Informal meeting areas 4 extra
- New desks and rooms shown as drawn in green
- Low Storage 29 actual. (a total gain)

Date : 07/03/2013
Drawing: SMP West 1st Fl 070313
Drawn : JW

Site Location:
Slough Borough Council
St Martins Place,
Bath Road,
Slough

All dimensions shown are approximate and must be checked on site prior to building

Copyright
This drawing remains the property of
Slough Borough Council



working with



Styles House Wood Street
Waddesdon HP18 0NN
Design office 01296 658463
Administration 01296 655329

EXISTING

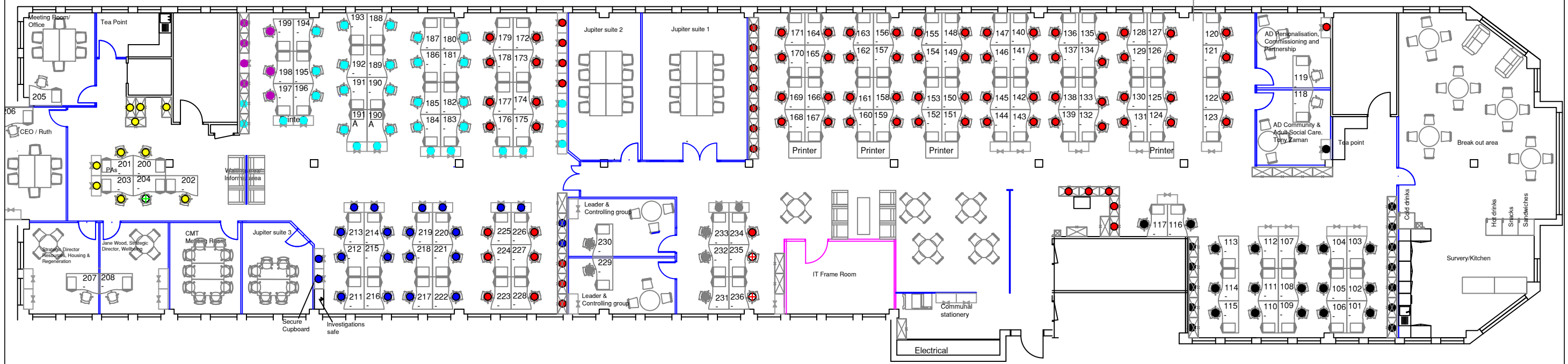

PROPOSED

